

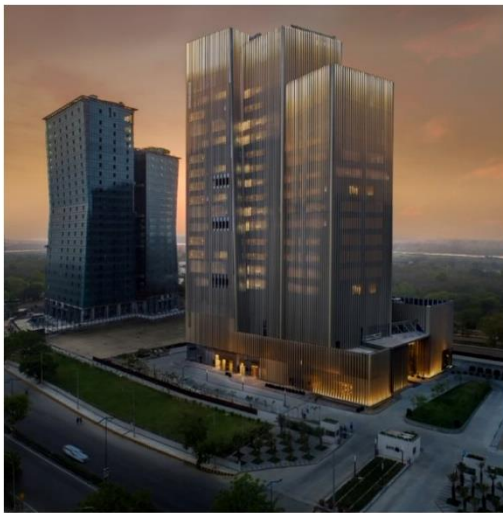

SEVABHAV | EXCELLENCE | CREDIBILITY

WASTE MANAGEMENT POLICY

CORPORATE SUSTAINABILITY STRATEGY



MAX ESTATES LIMITED



To know more about our Sustainability Strategy, scan the QR code

Contents

1. INTRODUCTION	2
2. PURPOSE	2
3. SCOPE.....	2
4. TARGETS AND COMMITMENTS	2
5. IMPLEMENTATION STRATEGY	2

1. INTRODUCTION

MEL strives to manage its environmental impact in a sustainable manner and acknowledges the need for prudent waste management toward sustainability.

2. PURPOSE

The purpose of this document is to provide instructions for appropriate waste management and handling during the project's occupancy phase.

3. SCOPE

3.1 Major inclusions and exclusions

This policy applies to existing and under development assets.

Engaging all relevant stakeholders including the community, statutory & regulatory agencies, non-governmental bodies, technical and subject matter experts, business partners, contractors, clients, occupants, and our own employees in our efforts of waste management.

4. TARGETS AND COMMITMENTS

We recognize the importance of managing and controlling all waste generated in accordance with legal requirements and our pollution prevention policy. MEL strives to meet the regulatory requirements for the various waste categories (hazardous waste, solid waste, biomedical waste, liquid waste, and e-waste).

MEL has created a comprehensive waste management strategy that includes the following components:

- **Identifying different types of waste, such as hazardous and non-hazardous waste, and ensuring appropriate waste management mechanisms are in place**
- **To avoid cross-contamination, hazardous and non-hazardous waste streams should be separated at the source.**
- **Minimizing waste at the source and optimizing resource use in our operations to cut waste.**
- **Promote recycling and diversion of waste from landfills.**
- **In-office development, equipment such as organic waste converters are being used to recycle food waste.**
- **Applying appropriate methods to handle and dispose of electronic waste in a safe manner.**

Waste Management Policy

- **Ensuring waste storage (hazardous and non-hazardous waste) in accordance with applicable legal requirements at the storage yards, adequate signage, and fire protection will be provided, as well as waste-handling personnel training.**
- **Work with tenants to drive waste management and disposal.**
- **Ensuring waste and debris disposal in accordance with applicable legal requirements**
- **Deploying construction and demolition waste handling, storage & diversion techniques at construction sites to minimise impact of waste generated during construction activities**