

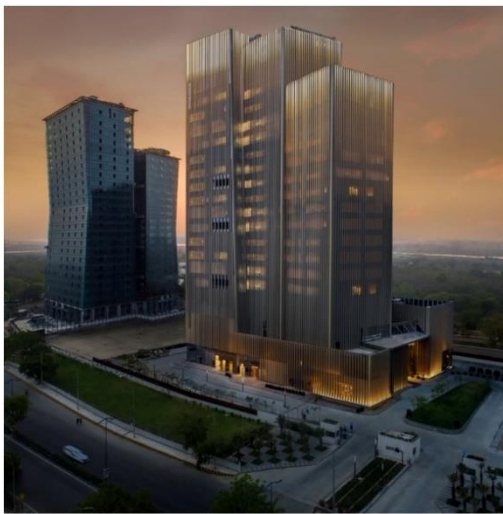

SEVABHAV | EXCELLENCE | CREDIBILITY

RENEWABLE ENERGY – EXISTING AND NEW DEVELOPMENTS

CORPORATE SUSTAINABILITY STRATEGY



MAX ESTATES LIMITED



To know more about our
Sustainability Strategy, scan
the QR code

Contents

1. INTRODUCTION	2
2. PURPOSE	2
3. SCOPE	2
4. TARGETS & COMMITMENTS	2

1. INTRODUCTION

We at MEL strive to minimize our impact on the Environment and recognize the need to adopt renewable sources of energy. It will reduce our greenhouse gas emissions and air pollution from combustion of fossil fuels for energy generation. It will drive us to become more energy efficient and move towards higher levels of sustainability.

2. PURPOSE

Explore and establish to promote the adoption of Renewable Energy in all design, construction & operation of existing and new developments.

3. SCOPE

This policy is applicable to all existing and new developments under the purview of MEL.

4. TARGETS & COMMITMENTS

This section will contain descriptions of all targets proposed within this Renewable Energy Policy as well as the level of MEL's commitments to achieve those targets

- **Ensure 100% compliance to applicable regulations.**
- **Analysing and maximising the on-site renewable sources including but not limited to biomass, geothermal, wind, solar etc.**
- **Exploring space availability, and the optimum orientation of the solar panels for incorporating maximum possible on-site renewable energy generation.**
- **Exploring the mechanism to utilize the excess energy generation during non-operating hours.**
- **Exploring off-site renewable energy sources where space for on-site renewable is not achievable, this we will achieve through techno-commercial feasibility analysis**